



# COASTAL AURORA

## MULTICAT 2712



### CLASSIFICATION / FLAG

Built	2014
Flag	Dutch
IMO	9698082
Classification society	Bureau Veritas
Service notation	Special service/ Multipurpose ship
Navigation notation	Unrestricted navigation
Call sign	PGDD
Class notation	1✠ Hull ● Mach ● AUT-UMS

### PRINCIPAL DIMENSIONS

Length o.a	27.27 m
Breadth o.a	11.5 m
Draft	min. 2.85 m - max. 3.06 m
Depth at sides	3.9 m
Deadweight	222 tons
Total clear deck space	150 m <sup>2</sup>
GRT	296
NRT	88

### DECK EQUIPMENT

Deck cranes	2 x Heila HLRM 230-4SLK 9.8 tons at 16.5 m
AHT winch	Max hold force 150 ton, 115 tons at 3 m/min, 63 tons at 5.4 m/min, wire cap 1000 m/65mm
Tugger winch	12 tons 20 m/min
Towing hook	Mampaey aft 33 tons
Towing pins foredeck	WK double pin type with chainstopper
Capstan	5 tons - 30 m/min

### MACHINERY / PROPULSION

Maximum speed	10 knots
Economic speed	8 knots
Total power	1790 kW at 1800 rpm
Main engines	2 x CAT C32 ACERT 895 kW
Generator sets	2 x Cat C04.4, 108kVa
Hydraulic power	Cat C12 TA, 339kW 1800 rpm
Propulsion	2 x fixed propellers in optima nozzles
Bow thruster	Tunnel type 184 kW hydraulic driven
Bollard pull	34 tons

### TANK CAPACITIES

Total fuel	109.5 m <sup>3</sup>
Sewage	10.5 m <sup>3</sup>
Fresh water	31.4 m <sup>3</sup>
Technical water	51.8 m <sup>3</sup>

### ACCOMMODATION

Bunks	7
<i>incl. single cabins</i>	3
<i>incl. double cabins</i>	2
Comfortably heated and air conditioned accommodation	

### COMMUNICATION AND NAVIGATION

GMDSS	A1, A2, A3
-------	------------

### SAFETY EQUIPMENT

Fire fighting system	
Medical chest	



# COASTAL AURORA

## MULTICAT 2712

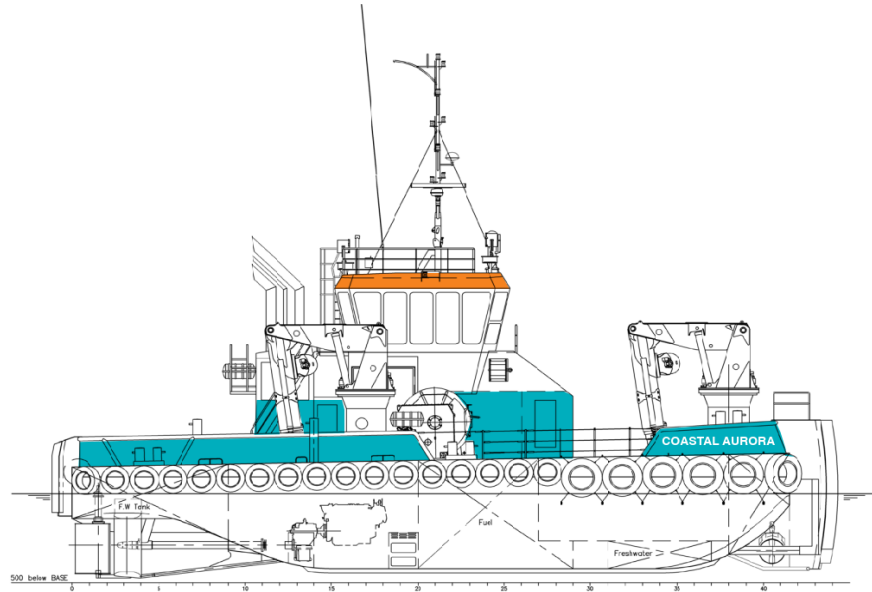

Main deck

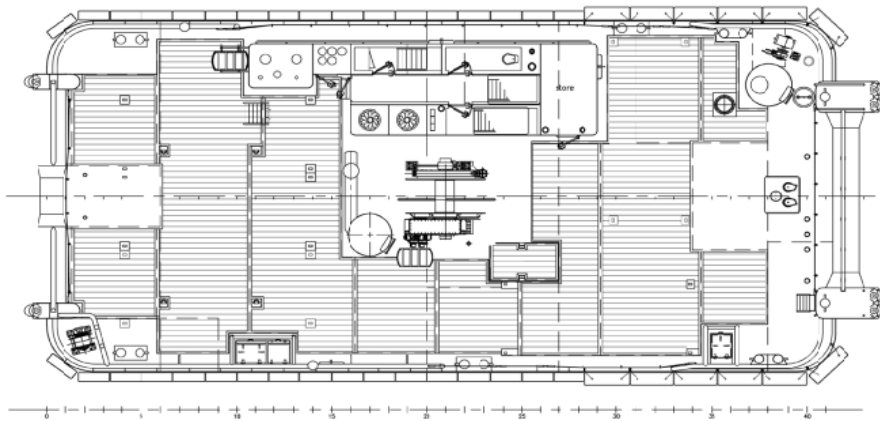

Below main deck

